

# WINTON 10 OWNER'S HANDBOOK

All the info you need to know when using your  
Ezytrail Winton Caravan



[www.ezytrail.com.au](http://www.ezytrail.com.au)



Read owner's manual before using the equipment. Third party component manuals should be read in conjunction with this manual. Maintenance guidelines must be met or exceeded, failing to meet these guidelines may result in serious injury or death and property damage.

# INDEX

Introduction	3	Important Safety Notice	17
<b>ABOUT YOUR CARAVAN</b>	<b>5</b>	Break Adjustment	17
Specifications	5	Brake Cleaning and Inspection	17
Bearings and Seals	5	Magnets	18
<b>SETTING UP YOUR CARAVAN</b>	<b>6</b>	Shoes and Linings	18
Loading your Caravan	6	Corrosion Prevention	18
Hitch and Unhitch your Caravan	7	<b>WHEELS AND TYRES</b>	<b>19</b>
Choosing a Spot to Set Up	8	Highway	19
Levelling your Caravan	8	Jacking your Caravan	19
Awning	8	<b>ELECTRICAL SYSTEMS</b>	<b>20</b>
Site Power	8	Chargers	20
Packing up your Caravan	9	Battery Care	20
Preparing for Bad Weather	10	Control Panel	21
<b>STORAGE AND CARE</b>	<b>10</b>	<b>GAS &amp; WATER SYSTEMS</b>	<b>22</b>
Long Term Storage	10	Hot Water System	22
Interior	10	Induction Cooktop	23
Exterior	10	Protecting from Mould	23
Batteries	10	<b>TRIP CHECKLIST</b>	<b>24</b>
Internal Surfaces	11	<b>USEFUL ACCESSORIES</b>	<b>25</b>
Acrylic Windows	11	Levelling Blocks	25
Mirrors	11	Wheel Chocks	25
Shade and Screen Care	11	Covers	25
Toilet Care & Maintenance: Chemicals	11	Stone Protection	25
Securing your Caravan	12	<b>TROUBLE SHOOTING</b>	<b>26</b>
<b>TORQUE SETTINGS</b>	<b>13</b>	Electrical	26
Wheel Nuts	13	Water	27
Hitch	13	Gas	27
Trailing Arm Pivot Bolts	13	Hot water	27
<b>BRAKES AND HANDBRAKE</b>	<b>14</b>	Brakes	28
Brake Controller	14	<b>HANDY TIPS</b>	<b>29</b>
Operation	14	Trip Planning	29
Trailer Plug Wiring	14	<b>WARRANTY STATEMENT</b>	<b>30</b>
Breakaway Switch	15	<b>MAINTENANCE</b>	<b>32</b>
Hand Brake	16	<b>MAINTENANCE SCHEDULE</b>	<b>33</b>
Adjuster	16	<b>APPENDIX</b>	<b>44</b>
Correct Use of your Electric Brakes	17	Appendix A3 - AWNING	44

# INTRODUCTION

---



**WARNING-** Before using this product you should read this manual and those manuals supplied by component manufacturers applicable to this product.

This manual is supplied as a reference to required maintenance of your new Ezytrail Caravan. Failure to use and maintain the product in accordance with what is outlined in this manual may affect your warranty.

Incorrect and/or insufficient maintenance may cause product failure resulting in property loss, damage, injury or death. Maintenance intervals are critical for normal use, extreme use may require shorter or additional maintenance intervals.

Manual content does not imply, express or other any warranty, the owner should read the limited warranty terms included in this booklet.

Before using this product, you should be certain your tow vehicle is suitably rated and equipped to tow the product safely and legally. The trailer and vehicle pairing must be within the safe "Maximum Towing Capacity", "Ball Weight Capacity" and "Gross Combination Mass" as stated by the vehicle manufacturer.

This caravan is fitted with electric brakes and a "Breakaway System". Requirements for breakaway systems can vary from state to state. It is mandatory to supply a maintenance charge to the breakaway battery source while driving. You MUST ensure this capability is fitted to your vehicle. The maintenance charge is supplied to the caravan via the Anderson plug on the drawbar.

**WARNING:** BALL LOADING (DOWNWARD LOAD ON TOW HITCH) MUST NOT EXCEED 300KG OR THE MAXIMUM ALLOWABLE LOAD BY THE VEHICLE MANUFACTURER OR TOW BAR RATING, WHICH EVER IS THE LOWEST. Exceeding these limits may result in an accident causing serious injury or death and/or property damage.

It is important to load your caravan correctly to distribute weight evenly and achieve a suitable ball weight load and prevent loading in a manner that can cause a camper to sway and/or roll excessively left and right. The optimum ball weight on a caravan is between 9 and 11% of the total camper weight.

## TERMINOLOGY & ABBREVIATIONS

**Ball Weight:** The downward load exerted on the tow point of the vehicle by the trailer

**Tare Weight:** The total weight of the unoccupied, unladen trailer ready for use with all included fitments from the supplier. Empty water tanks.

**ATM (Aggregate Trailer Mass):** The total mass of the laden trailer when carrying the maximum load recommended by the manufacturer. This includes any mass imposed upon the drawing vehicle when the combination vehicle is resting on the horizontal supporting plane.

**GTM (Gross Trailer Mass):** The mass transmitted to the ground by the axle or axles of the trailer when coupled to a drawing vehicle and carrying its' maximum load approximately uniformly distributed over the load bearing area.

**GCM (Gross Combination Mass):** This is the total allowable combined mass of tow vehicle and trailer as determined by the tow vehicle manufacturer

**Camber:** Camber angle is the measure in degrees of the difference between the wheels vertical alignment perpendicular to the surface. If a wheel is perfectly perpendicular to the surface, its camber would be 0 degrees. Camber is described as negative when the top of the tyre begins to tilt inward towards the chassis rail.

# ABOUT YOUR OFFROAD CARAVAN

✓ Standard  
✗ Optional  
 N/A Not Available

Model	WINTON 10
Type	10ft
Tare	1050kg
ATM	1500kg
Ball Weight	70kg
Body Construction - Aluminum wall frames with composite exterior walls and GEL coated FRP interior walls	✓
Customisable colours	✓
EZY-RIDER Suspension System	✓
Offroad Ball Hitch	✓
External Kitchen	N/A
Internal Kitchen	✓
Water Tank - 2 x 80L poly water tanks	✓
Water system - Fully Plumbed Hot/Cold Water - snake track with permanent water plumbing connected to kitchen via braided flexible hoses, John Guest Plumbing pipes and fittings	✓
4 x Drop Down Adjustable Legs	✓
Jockey Wheel	✓
1x 4.5L Gas Bottle Holder	✓
14inch Alloy Wheel	✓
10" Electric brakes with Hand Brake	✓
Integrated 4 Speaker Entertainment System with CD/DVD/USB playback & Bluetooth Function with 24 inch HDTV	✗
1x 100Ah Deep Cycle Batteries	✓
12V and 240V Power Electric System	✓
Internal Bathroom - Ensuite with Premium Shower, Sink & Cassette Toilet	✓
External shower	✗
USB Outlets	✓
Truma ultrarapid gas/electric 14L	✓
Awning	✗
Moon window	✓
Air Conditioning	✗
Projecta PM100 System - Lithium compatible	✓
RV 50L fridge/freezer	✓
TV System: 24 inch HDTV	✗

## BEARINGS AND SEALS

Inner bearing/cup	Outer bearing/cup	Seal	Grease cap
LM68110-L68149	LM12749-LM12710	492015	48mm

# SETTING UP YOUR CARAVAN

## LOADING YOUR CARAVAN

When heading away on your next big adventure it is important to load your caravan correctly to distribute weight evenly and achieve a suitable ball weight load and prevent loading in a manner that can cause a caravan to sway and/or roll excessively left and right. The optimum ball weight on a caravan is between 9 and 11% of the total caravan weight.

**WARNING: BALL LOADING (DOWNWARD LOAD ON TOW HITCH) MUST NOT EXCEED 300KG OR THE MAXIMUM ALLOWABLE LOAD BY THE VEHICLE MANUFACTURER OR TOW BAR RATING, WHICHEVER IS THE LOWEST.**

Exceeding these limits may result in an accident causing serious injury or death and/or property damage.

- Always load both sides of the caravan evenly
- Load heavy items low and directly over the axle.
- Secure all items to prevent damage to the caravan during travel.
- Consider water tank levels and how they may affect the balance front and back and the percentage of ball weight.
- Overhead cupboards should only be used for lightweight items such as clothes, personal items, bedding etc.
- Never store heavy items in overhead cupboards.
- Heavy cooking equipment should be stored in lower cupboards.
- Tinned and bottled food for cooking etc should be stored in the pantry cupboard.
- Never load in a manner that causes the ball weight to exceed the limit of the tow vehicle.
- The diagram below illustrates best placements of items based on weight.

This caravan is fitted with electric brakes and a "Breakaway System". Requirements for breakaway systems can vary from state to state. It is mandatory to supply a maintenance charge to the breakaway battery source while driving. You MUST ensure this capability is fitted to your vehicle. The maintenance charge is supplied to the caravan via the Anderson plug on the drawbar.



# SETTING UP YOUR CARAVAN

## HITCH AND UNHITCH YOUR CARAVAN



1. Reverse vehicle so tow ball is under hitch.  
Wind Jockey wheel down



2. Ensure hitch lock is lifted up



3. Wind jockey wheel down onto tow ball and ensure hitch lock is down



5. Plug in the Anderson plug into rear of vehicle



4. Plug the 7-pin trailer plug into its socket



6. Place chains on



7. Remove breakaway switch from unit and wrap cord around tow bar



8. Plug breakaway switch back into unit



9. Wind up jockey wheel, pull handle and lock into place

## CHOOSING A SPOT TO SET UP

When you arrive at your camp for the night it is important to choose a good spot to camp. One that will allow you to rest easy. When choosing a spot to set up your caravan, start with a flat area with no overhanging trees. Birds and bats occupying trees can leave droppings on your caravan that can damage paint. Sap can also stain the coating. Ensure you are not camping in an area prone to flooding or with bad drainage in the event of rain. Even the slightest hollow in the ground can put you in a mini lake. In hot weather if possible, set your caravan up so the sun's arc goes from front to back or back to front with the annex/awning in the general direction the sun is arcing across. Doing this will keep the bulk of the caravan in shade and the inside cooler as it will be shaded by the awning. **Please note that when choosing a set up spot you do have to consider your solar panels and the sun that charges them.**

## LEVELLING YOUR CARAVAN

Levelling front to back can be done by raising and lowering the jockey wheel prior to adjusting the stabiliser legs.

The stabiliser legs on your caravan are not designed for supporting the full weight of the trailer, they are there to stabilise it once it is level.

Getting the trailer level from left to right should be done with drive on stepped ramps as illustrated here.

Once levelled the legs can be lowered to keep the trailer stable. On soft ground you may want to use timber boards under the stabiliser feet.

**Using your stabilisers as a lifting mechanism will void your warranty as will extending them with a rattle gun, impact wrench or electric drill/drill driver .**



## AWNING

When extending the awning always support the front as it extends. Do not allow the awning to carry the full extended weight as this may damage the hinges. Support the end manually by hand or by using the extendable legs

**See appendix A3 for instructions on how to set up your awning**



## SITE POWER

The onboard charger in your caravan is connected via the 15A exterior socket.

To use site power, you will require a 15A power lead connected to a 15A outlet, as shown. In the event a 15A outlet is unavailable you will need a conversion box that will step up from 10A to 15A with a safety switch. Never leave power leads coiled when in use, lay the lead out back and forward in a manner that won't be a trip hazard or risk damage to the lead.

# PACKING UP YOUR CARAVAN

---

## PACKING DOWN YOUR CARAVAN

When packing down your caravan check the following:

- Turn off all gas and electric appliances
- Gas is turned off at the gas bottle - appliance hoses are disconnected and stowed
- Pack away and secure all loose items so they can't move and damage themselves or the caravan
- Secure and lock all cabinet doors, and close all drawers
- Remove and stow the site power lead
- Ensure doorstep is raised and secured
- Ensure all windows are closed and locked
- Close and lock the main door
- All dust covers in place and secure



# EXTRAS

---

## PREPARING FOR BAD WEATHER

During bad weather such as rain, wind, or cyclone, the following should be done:

- Close all roof vents and hatches to prevent water entering.
- Protect the awning from high winds by retracting or securing with guy ropes and pegs.
- Ensure your caravan is not parked in ground that will become boggy and prevent exiting the camp area
- Close all external doors and hatches to prevent water ingress and wind damage

# STORAGE AND CARE

---

## LONG TERM STORAGE

To maximise the life of your caravan you should consider additional protection from the elements. UV light and moisture can have an adverse effect on materials when left unprotected outside. This section outlines some of the things you can do as an owner to protect your investment.

## INTERIOR

Moisture and your camper are not friends, in fact they are your enemy. Here are some tips to reduce moisture and avoid mould. High humidity and cooling temperatures can create condensation, additionally condensation can form under mattresses due to temperature differences between warm bodies on top and the bed base being cold from outside temperatures.

As a precaution you can do the following:

- Check under mattress for moisture before packing up. If moisture is found allow to thoroughly dry before closing your caravan.
- Store 1 or 2 moisture absorbing packs/dehumidifier packs in the caravan to draw away any residual water vapour.
- If packing up with damp or humid conditions, open and dry out the caravan at the first opportunity when returning home. Dry all canvas thoroughly and follow point 2.

## EXTERIOR

Ensure all seals on the caravan have proper compression at 30-50%, are free of dirt and have nothing protruding past the seals. UV light and the elements can over time cause seals and fittings to perish and become brittle. The use of a camper cover or tarpaulin will extend the life of components and keep your investment looking better for longer.

# STORAGE AND CARE

---

## BATTERIES

When storing your caravan, make sure all power is turned off to ensure batteries aren't drained. Batteries should be maintenance charged at least monthly when stored.

If storing for a period longer than 1 month, consider a trickle charge setup, or a 24hours charge on 240V every few weeks. Do not leave the 240V charge on constantly, as the battery memory can be affected.

**Allowing batteries to cycle below 12.5 volts regularly will shorten battery life and permanently damage them. Prior to storage batteries must be charged to 100% for 24hours.**

## PAINTWORK

The paint coatings on your caravan are no different to that of your car in that they need regular care and maintenance.

**Washing:** Only use mild detergents free of ammonia when washing your caravan. Always check the label to ensure the washing solution is nonabrasive, contains no ammonia or caustics.

**Polishing:** New caravans should only be polished with wax-based polishes that are nonabrasive. When removing scratches from paintwork use a fine finishing compound. Cutting pastes are too abrasive and will expose the base material.

**Protection:** Carnauba wax is an excellent protection against oxidation. The paint on your caravan should be waxed annually regardless of being kept under cover to protect the surfaces from oxidation.

## INTERNAL SURFACES

Laminates and internal wall surfaces should be cleaned with a damp soft cloth. For stubborn marks use a mild detergent based cleaner.

**\*\*Do not use cleaners that contain ammonia or caustics\*\***

## ACRYLIC WINDOWS

Windows should be cleaned with a clean, soft, nonabrasive cloth to avoid scratches and soapy water.

**\*\*Do not use cleaners that contain ammonia or solvents\*\***

## MIRRORS

Do not use solvents or chemicals when cleaning mirrors. Warm water and a soft clean cloth is the best method. Cleaners and solvents may affect the reflective backing causing what's known as "creep" where the edges of the mirror discolour.

## SHADE AND SCREEN CARE

- Do not close blinds while window is open. Air pressure can dislodge the blind material from its guide damaging it.
- Always open and close blinds and screens carefully and evenly with two hands ensuring screens and blind material feeds evenly through the guides.

## TOILET CARE & MAINTENANCE: CHEMICALS

Always use water treatment and conditioning products recommended by the manufacturer.

*Thetford*

Waste Holding Tank: The recommended product for the waste holding tank on Thetford toilet systems is Aqua Kem Blue or Aqua Kem Green for better environmental performance.



Cleaning Cassette Tank: "Cassette Tank Cleaner" is the recommended product for this application.



Flush Water Tank: Only suitable for Ezytrail models that have a toilet flush tank. \*\*\*Do not add to main water tanks!  
\*\*\* Thetford recommend "Aqua Rinse"



Bowl Cleaning Products



## SECURING YOUR CARAVAN

When parked and unhitched you should always use suitable wheel chocks to ensure the trailer can't move in the event of a handbrake failure. For security a wheel clamp or and hitch lock are highly recommended.

# TORQUE SETTINGS

## WHEEL NUTS

Wheel nuts should be tightened to correct torque using a torque wrench. Never trust a “rattle gun” as these may over or under tighten. A quality torque wrench will ensure nuts are tightened correctly. It's important to remember to check your wheel nuts at **50km, 100km, and 500km** and periodically thereafter.

The correct torque settings are: **135Nm (100ft-lbs) for 1/2" studs or 190Nm (140 ft-lbs) for 9/16" stud.**



**IMPORTANT INFORMATION**

Wheel nuts must be re-torqued to **135Nm (100ft-lbs) for 1/2" studs or 190Nm (140 ft-lbs) for 9/16" stud.** after the first **50km 100km, and 500km**, or after the wheels have been re-mounted, and then at periodic intervals. Wheel nuts should be checked **DAILY** when on rough or unsealed roads.

Re-torque as per the diagram on the right:

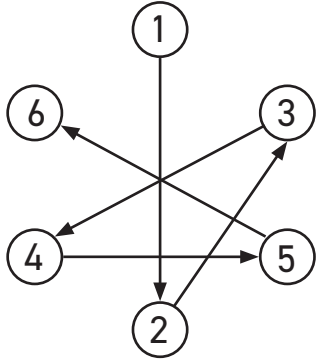

## HITCH

The high tensile bolts securing your hitch should be tightened to **180Nm**. These should be checked at 5,000km intervals.

## TRAILING ARM PIVOT BOLTS

The pivot bolts are a high tensile steel. The service interval for these bolts is **1,000km** after delivery, **10,000km** under normal use and **5,000km** for harsh off-road conditions. During travel they should be inspected daily to ensure they have not rotated or become damaged. Correct torque is **190Nm**

# BRAKES AND HANDBRAKE

## BRAKE CONTROLLER\*

Your trailer is fitted with electric brakes that require a brake controller that can be operated from the drivers seat.

1. Manually adjustable to provide the correct braking capability for varying road, off-road and load conditions.
2. They can be modulated to provide variable braking force, thus easing the brake load on the towing vehicle.
3. There is very little lag time between the moment the tow vehicle's brakes are actuated and the moment the trailer brakes are actuated.
4. They can provide some braking independent of the tow vehicle in the event of an emergency.

\*The requirements can vary from state to state. It's important to check what is required in your state.

## OPERATION

When electrical current is fed into the system by the controller, it activates the electromagnets in the brakes. These electromagnets are energized and are attracted to the rotating surface of the drums which moves the actuating levers in the direction that the drums are turning thus applying pressure from the brake linings to the drum surface.

## TRAILER PLUG WIRING

The following diagrams outline the correct wiring for flat and round 7 pin plugs:

Pin No.	Circuit	Colour
1	Left-Hand Turn	Yellow
2	Reversing Signal	Black
3	Earth Return	White
4	Right-Hand Turn	Green
5	Service Brakes	Blue
6	Stop Lamps	Red
7	Rear Lamps, Clearance & Side Marker Lamps	Brown



### Cable Entry View

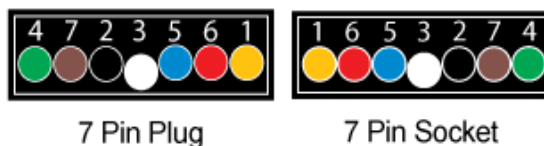

# BRAKES AND HANDBRAKE

## BREAKAWAY SWITCH

By law\*, all trailers with a GTM of 2000kg or greater must have a "Breakaway System" to halt the trailer in the event it becomes detached from the tow vehicle whilst traveling. Your caravan is fitted with this system with the switch mounted on the drawbar with a steel wire lanyard to connect to your tow vehicle. In the event that the caravan becomes detached, the lanyard will pull the pin from the breakaway switch and the onboard batteries will activate the brake system. The lanyard must be attached to a solid part of the vehicle. It is a mandatory requirement that power be supplied by the tow vehicle to the breakaway power source while towing. This is done via the 50amp Anderson Plug on the drawbar. Consult a qualified auto electrician to ensure this is fitted to your tow vehicle.

In NSW there is an additional requirement that the breakaway power source be monitored from the driver position with a minimum of a "visual alarm" for low battery voltage. Consult a qualified auto electrician to ensure this is fitted to your vehicle.

\*Each state can have different laws in regards to brakeaway systems.  
It's important to check what is required in your state.



Breakaway Switch



Anderson Plug

### CAUTION:



- DO NOT CONNECT THE BREAKAWAY LANYARD TO THE SAME POINT AS THE SAFETY CHAIN SHACKLES.
- DO NOT USE THE BREAKAWAY AS AN ALTERNATIVE TO THE HANDBRAKE AND DO NOT REMOVE THE PIN AS AN ALTERNATIVE SECURITY MEASURE. REMOVING THE PIN WILL RAPIDLY DISCHARGE THE BATTERIES.
- IT IS A MANDATORY REQUIREMENT THAT THE BREAKAWAY BATTERY SOURCE BE CHARGED DURING TOWING.
- NSW REQUIRES A BATTERY MONITOR VIEWABLE FROM THE DRIVERS POSITION WITH A MINIMUM OF A VISUAL ALARM FOR LOW BATTERY VOLTAGE

## HAND BRAKE

Parking brakes are mechanically operated by a cable.

Use the cable adjuster to give enough tension to be able to set the handbrake lever on the last two notches of the coupling or handbrake is 1/3 raised when unladen. This needs to be checked again when the trailer or caravan is loaded. If the cable is too tight, the brakes will be applied as the axle moves backward under spring deflection.

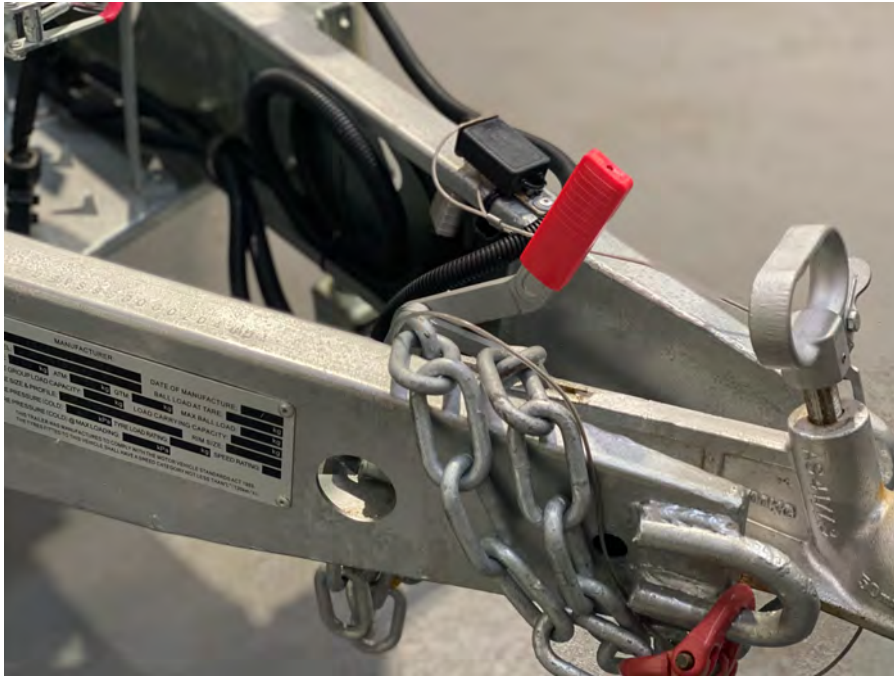

## ADJUSTER

To adjust the handbrake cable tension release locknuts. To tighten the handbrake cable, turn the adjuster wheel in a clockwise direction. Once adjusted retighten lock nuts and test. Always ensure that wheels turn freely when handbrake is off. Overtightened cables can cause brakes to drag and damage the brake linings.

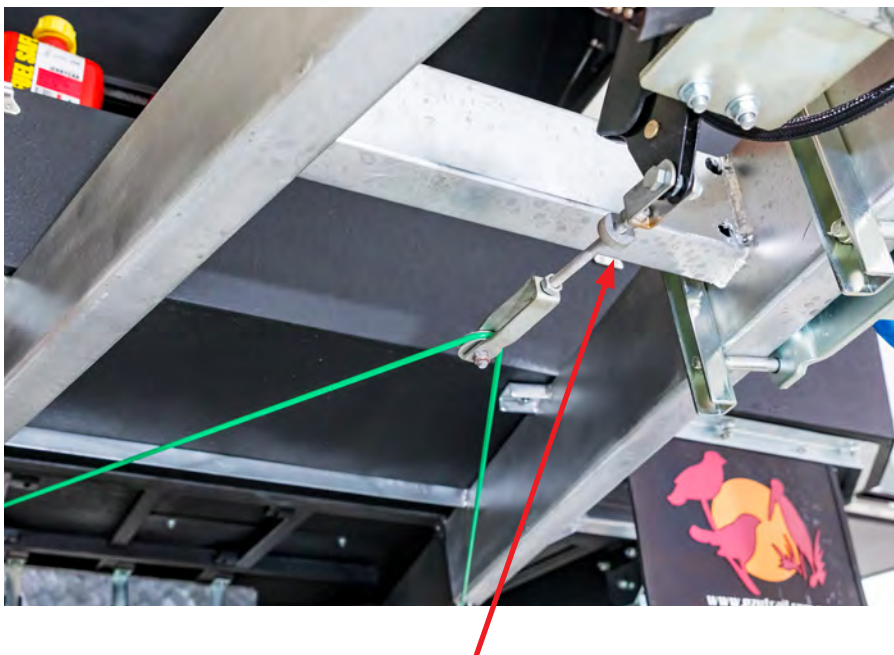

Adjuster Wheel

# BRAKES AND HANDBRAKE

## CORRECT USE OF YOUR ELECTRIC BRAKES

Your trailer brakes are designed to work in synchronisation with your tow vehicle brakes.

Never use your tow vehicle or trailer brakes alone to stop the combined load. Your trailer and tow vehicle will seldom have the correct amperage flow to the brake magnets to give you comfortable, safe braking unless you make proper brake system adjustments. Changing trailer load and driving conditions, as well as uneven alternator and battery output, can mean unstable current flow to your brake magnets.

It is therefore imperative that you maintain and adjust your brakes as set forth in the controller manual, use a properly modulated brake controller and perform the synchronisation/adjustment procedure recommended by the brake controller supplier.



### IMPORTANT SAFETY NOTICE

Proven and in some cases approved service methods and correct repair procedures are essential for the safe, reliable operation of the brakes, suspension and axles as well as the personal safety of the individual doing the work.

The numerous variations in procedures, techniques, tools and parts for servicing axles, as well as in the skill of the individual doing the work will determine outcomes. This manual cannot possibly anticipate all such variations nor provide advice or cautions as to each. Accordingly, anyone who departs from the instructions provided in this manual must first establish that they neither compromise their personal safety nor the vehicle integrity by their choice of methods, tools or parts.

**\*IF AT ALL IN DOUBT PLEASE REFER ALL REPAIRS AND MAINTENANCE TO A SUITABLY QUALIFIED OR EXPERIENCED MECHANICAL REPAIRER.**

**\*EZYTRAIL CAMPERS ACCEPTS NO LIABILITY FOR PERSONAL INJURY, LOSS OR DAMAGE RESULTING FROM INCORRECT APPLICATIONS, METHODS AND FAILURE TO PERFORM MAINTENANCE SAFELY AND CORRECTLY.**

## BRAKE ADJUSTMENT



Brakes should be adjusted:

1. after the first 1,000km of operation when the brake shoes and drums have "burnished"
2. at no more than 10,000km intervals.
3. or as use and performance requires.

Never crawl under your trailer unless it is resting on properly placed jack stands. Do not place supports on any part of the suspension system and use the designated jack point or under the spring base plate to jack trailer.

## BRAKE CLEANING AND INSPECTION

Your trailer brakes must be inspected and serviced at 10,000km or more often as required by use and performance. Magnets and shoes must be changed when they become worn or scored to avoid inefficient vehicle braking.



### BRAKE LUBRICATION

This should only be done by qualified persons.

**CAUTION - DO NOT GET GREASE OR OIL ON THE BRAKE LININGS, DRUMS OR MAGNETS.**



## MAGNETS

Your electric brakes are equipped with high quality electromagnets that are designed to provide the proper input force and friction characteristics. Your magnets should be inspected and replaced if worn unevenly or abnormally.

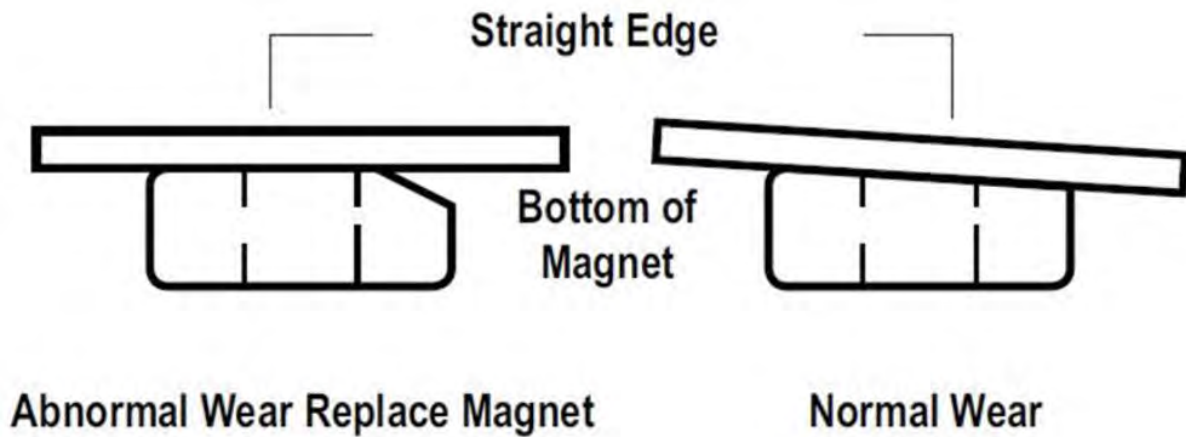

Even if wear is normal as indicated by your straightedge, the magnets should be replaced if any part of the magnet coil has become visible through the friction material facing of the magnet. It is also recommended that the drum armature surface be refaced when replacing magnets.

- Magnets should also be replaced in pairs - both sides of the axle.
- Always use genuine OEM parts.

## SHOES AND LININGS

A simple visual inspection of your brake linings will tell if they are useable.

Replacement is necessary if the lining is worn (to within 1.5mm or less), contaminated with grease or oil or abnormally scored or gouged. It is important to replace both shoes on each brake and both brakes of the same axle. This is necessary to retain the "balance" of your brakes.

Be sure to replace your shoes only with genuine parts available from our outlets.

## CORROSION PREVENTION

It's important to take steps to prevent corrosion of parts on your trailer to extend the service life. Many fittings are high tensile or zinc plated. Fittings such as this can benefit from additional protection. Some helpful products to prevent corrosion are "Lanotec", "WD40", "Inox" and similar products. These can be spray applied and do a very good job of protecting metal surfaces, particularly in corrosive and aggressive environments near the ocean and inland waterways.

Often, we take our campers and caravans to salt water or brackish environments. Driving through salt water is never recommended as the residual chloride ions accelerate corrosion greatly. If you are camping near or driving through these kinds of environments, we highly recommend that your trailer be thoroughly cleaned after use. Flushing the chassis and washing and rinsing your trailer is important. **Please note that caravan will need a hand wax treatment at least annually.**

# WHEELS AND TYRES

---

## HIGHWAY

Recommended Settings:

- Tyre pressure (up to 2000Kg ATM) - 36 psi. (sealed highways)
- Tyre pressure (2000kg to 2500Kg ATM) - 55 psi (sealed highways)
- Tyre pressure (over 2500Kg ATM) - 70 psi (sealed highways)
- Wheel nuts - 135Nm (100ft-lbs) for 1/2" studs or 190Nm (140 ft-lbs) for 9/16" studs

## JACKING YOUR CARAVAN

Your Ezytrail caravan has bottle jack points located on each of the trailing arms on the suspension.

Never place any part of your body beneath the caravan when suspended by any kind of jack. Ensure the body of the caravan is protected from damage by the jack.

The jacking point on the trailing arm is designed for the head of a bottle jack to fit securely inside the metal ring. When using this point ensure the jack is on a solid base and the caravan cannot move.

# ELECTRICAL SYSTEMS

## CHARGERS

For detailed information on the appliances installed in your camper please refer to the manuals included in your camper handover.



### CAUTION

ELECTRICAL DEVICES CAN BE DANGEROUS. UNDER NO CIRCUMSTANCES SHOULD REPAIRS AND MODIFICATIONS BE ATTEMPTED BY UNQUALIFIED OR UNTRAINED PERSONS. EZYTRAIL ACCEPTS NO LIABILITY FOR ANY PERSONAL INJURY, DAMAGES OR LOSS AS A RESULT OF UNQUALIFIED OR UNTRAINED PERSONS REPAIRING OR ALTERING THE ELECTRICAL SYSTEMS ON THIS PRODUCT. IF IN DOUBT CALL YOUR LOCAL EZYTRAIL BRANCH

## BATTERY CARE

Your camper is fitted with 100Ah Deep Cycle Batteries, designed to allow you to stay off the grid longer. Maintaining these batteries will ensure a long service life. Storage type batteries require periodical maintenance to perform at their peak and extend their service life. The following is an outline on how to gain the best performance and lifecycle from the battery fitted in your camper:

- Give the batteries a maintenance charge at least once a month.
- When possible leave the battery connected to a smart charger that will cycle and maintain the battery during storage. If this isn't possible check and charge at regular intervals to prevent excessive discharge.
- If purchasing an after market battery charger always use a quality charger that caters to the voltage requirements of a deep cycle battery.
- Never leave your battery stored at low volts. Before storing your camper ensure that battery/s is fully charged, and all power is disconnected/switched off.
- When in use try to keep your battery at or as close to maximum capacity as possible.
- Never use unregulated solar power direct to your batteries.
- **Allowing your battery voltage to drop below 12.05V can permanently damage its performance and reduce its service life.- change to batteries from before**

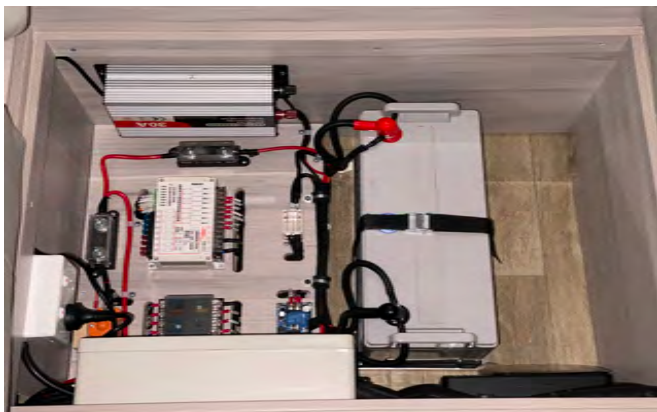

### DEEP CYCLE BATTERY - STATE OF CHARGE

Level	Voltage
100%	13.00V
90%	12.85V
80%	12.7V
70%	12.6V
60%	12.45V
50%	12.35V
40%	12.25V
30%	12.1V
20%	11.95V
10%	11.75V
0%	10.50V

# ELECTRICAL SYSTEMS

---

## CONTROL PANEL



PM 100

Downloadable from  
[www.projecta.com.au](http://www.projecta.com.au)

# GAS & WATER SYSTEMS

## HOT WATER SYSTEM

Your caravan is fitted with a Truma 240V/Gas 14L Water Heater .

Please read the manual provided with this system at the time of purchase.

For further information go to:

**PLEASE SEE TRUMA HOT WATER SYSTEM OWNERS MANUAL FOR INSTRUCTIONS**

- Supplied with your caravan

<https://www.truma.com/web/downloadcenter/files/truma-watersystems-ultrarapid-bga-installation-operating-aus-en.pdf>

**NOTE:** It can take up to a minute or so for the gas to purge the line and flow through the burners.



### WARNING:

- DO NOT OPERATE WHILST TOWING.
- DO NOT OPERATE IN ENCLOSED SPACES.

\*Please ensure to remove hot water system cover before use - as seen in photos below



# INDUCTION COOKTOP

## HOW TO USE:

1. Turn on device with the On/Off key - The power indicator lights up and the digital display shows power level
2. You can select power level (1-10) by turning the dial to the right + or the left -  
If the power level is not displayed, you should select it via the menu key
3. If the induction cooker detects an excess temperature on the hob during cooking it displays an error message E6  
The heating process is stopped and the device switches to stand-by mode for 60 seconds
4. The error message will not be cancelled until the temperature has dropped to below 100 degrees

## TIMER:

1. Press the menu key to select the timer function. The corresponding indicator lights up and the display shows 0:00
2. You can now set the time by turning the dial to the right or to the left. The maximum time that can be set is 12 hours
3. Once the time has been set, it will be displayed for 5 seconds and the time is counted down
4. After the set time has elapsed, an acoustic signal is emitted 5 times and the device switches to stand-by mode

## USABLE AND NON-USUABLE UTENSILS:

1. Usable pans

Steel, cast iron, enameled iron, stainless steel, flat-bottom pans/pots with diameter from 12-26cm



2. Non-usable pans

Heat-resistant glass, ceramic container, copper, aluminum pans/pots, rounded-bottom pans/pots with measuring less than 12cm

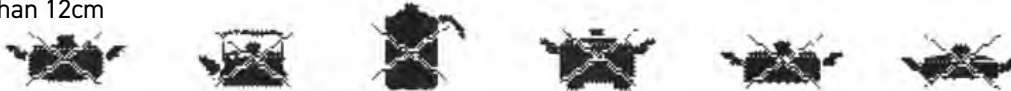

## PROBLEM AND SOLUTION:

ErrorCode	Reason	Solution
..	Waiting Status	Place a suitable pot/pan onto the induction cooking field. The plate will work as usual
E0	Use of wrong. Too small a pot	Use a correct pot
E2	Open Circuit	Please return the device for repair
E3,E4	Voltage too low. Too high	Connect the device to a correct power outlet
E5	Ceramic Plate is over heated	Allow the device to cool down. Turn it off completely and then on again
E6	Overheat Protection	Allow the device to cool down, turn it off completely and then on again

## PROTECTING FROM MOULD

Mould is very difficult to clean once a porous surface is affected. There are several ways you can prevent the occurrence of mould on your caravan:

- Never leave your caravan packed away with a wet interior.
- If you must leave a campsite with wet canvas or a damp interior, be sure to open and dry out your caravan thoroughly at the very first opportunity when you get home. Mould can develop in just a couple of days so don't take the risk.
- When packing up dry, it is important to check under the mattress that there is no build-up of condensation overnight. Body heat on a mattress can create enough temperature difference between the interior and exterior for moisture to form under it. If left unchecked this can cause mould when your caravan is stored.

You can also keep a moisture absorber product such as DampRid, Hippo, or other silica gel dessicants, in your Winton van while it is stored to help attract and absorb any potential moisture.

# TRIP CHECKLIST

Working from a checklist will help avoid forgetting important tasks particularly in regard to safety. Individual camper set ups may differ depending on tow vehicle and any modifications made by the owner. The table below is for guidance only, space is left for you to add your own checklist points:

PRE HOOK UP			
Safety breakaway switch lanyard connected		Mains water input disconnected and capped	
Spare wheel carrier securely latched and locked		Grey water sullage pipe disconnected	
Windows latched and locked (caravans)		Roof latches and locking pins fitted/secure	
Handbrake lever released		Roof accessories lowered/stowed (caravans)	
Power system shut down (except essential services)			
Hot water system cover fitted and secure (Truma models)			
240V input lead disconnected and cover latch secure			

# USEFUL ACCESSORIES

---

## LEVELLING BLOCKS

These are excellent for levelling your trailer on set up. Stabiliser legs are not meant for correcting the trailer angle, they are there to keep it stable when people are in it. Using levelling blocks will extend the service life of the stabiliser legs and make set up much safer and faster. See below images.



## WHEEL CHOCKS

Wheel chocks are an important safety device when leaving your trailer parked on even the slightest incline. On level ground it is recommended to chock both sides of the wheel. On a hill you should chock the wheels on the downhill side ensuring the chocks are firmly pressed against the tyre.



## COVERS

Hard floor campers and caravans will benefit greatly from a storage cover. Perishable fittings such as rubber seals and plastic will be protected from UV radiation. Paint and gelcoat finishes will oxidise less and this will extend the service life of these finishes.

## STONE PROTECTION

There are proprietary devices available that assist in protecting your trailer from stones thrown up by the tow vehicle. Rock Tamer and Stone Stomper are two of the most commonly used.





# TROUBLE SHOOTING

## ELECTRICAL

PROBLEM	POSSIBLE CAUSE	SOLUTION
No 12V Power	Main Power Switch "OFF"	Turn on Main Power Switch
	Battery isolator switch off	Turn on
	Main circuit breaker tripped	Reset main circuit breaker
	Loose battery connections	Tighten terminals and connections
	Damaged wiring	Find damage and repair/replace
	Flat battery	Charge battery
Battery not charging	Charger turned off	Turn charger on
	No mains power	Indicated by charger not turning on. Check mains power, if charge still doesn't switch on, the charger may be faulty. Contact dealer for warranty or replacement.
	Tripped circuit breaker	Reset breaker
	Charger overheated	Rest for 30 minutes and try again. Ensure adequate ventilation around charger and allow to cool. Do not store items around electronics.
	Faulty charger	A charger fault will be indicated by fast flashing on the charger control panel. Contact dealer for warranty or replacement.
	Faulty battery	Have battery tested and replaced if faulty
Lights or plugs not working	Tripped circuit breaker 2	Reset breaker
	Poor connection 3	Find and rectify
	Circuit switch "OFF" 1	Check control panel and switch to "ON"
No power to fridge	Tripped circuit breaker	Reset breaker
	Poor connection	Find and rectify
	Circuit switch "OFF" 1	Check control panel and switch to "ON"
Indicators or park lights not working	Poor connections at trailer plug	Check and clean plug contacts. If pins are closed, use a knife or small screwdriver to separate the spit in pin slightly. This gap should be even along length of pin.
	Damaged Chassis wiring	Check and repair as required
Inverter not powering	Poor connection 2	Check 12V connections are tight
	Power switch is "OFF" 1	Turn on Main Power Switch
	Flat battery 4	Charge battery
	Inverter Fault Protection Indicator ON 3	Refer to User Manual
Circuit breaker tripping during use	Overloading	Check amperage draw from appliance
	Faulty appliance	Check appliance and rectify

# TROUBLE SHOOTING

## WATER

PROBLEM	POSSIBLE CAUSE	SOLUTION
Pump not working (no noise)	No power from control panel	Check circuit switch and circuit breaker
	Faulty pressure switch	Replace pump, Contact dealer for replacement
	Bad electrical connection	Check connections with multimeter or test light
	Flat Battery	Charge battery
Pump working but no water flow	Airlock in water lines	Turn on tap and hold finger over nozzle for 5 seconds and release. Repeat several times. If this fails, fill water tank and use mains pressure to pressurize tank
	Water tank is empty	Fill water tank
	Kinked hose	Check hoses ensuring none are fouled
	Damaged / worn pump diaphragm	Repair or replace pump

## GAS

PROBLEM	POSSIBLE CAUSE	SOLUTION
Cooker not igniting	Gas will not ignite	Replace PIEZO Battery
	Gas bottle empty	Fill gas bottle
	Gas bottle not turned on	Turn on valve on gas bottle
	Gas hose on cooker not connected	Check bayonet is securely connected into receiver
	Stove dirty	Clean stove of grease/dirt buildup
	Kinked hose	Check hose is not twisted and kinked
	Regulator blocked -	Get professional diagnosis and help

\* Remember that first use after connecting/reconnecting gas may take up to 2 minutes for the gas to purge the line to the cooktop. Once ignited hold the control knob down for up to 5 seconds.

## HOT WATER

PROBLEM	POSSIBLE CAUSE	SOLUTION
No Hot Water	Gas will not ignite	Refer to owners manual
	240V not connected	Connect and turn on as required

## BRAKES

PROBLEM	POSSIBLE CAUSE	SOLUTION
No brakes	Open Circuits	Find and correct
	Severe under adjustments	Adjust brakes
	Faulty controller	Test and correct/replace
	Short circuits	Find and correct
Weak Brakes	Grit or oil on linings or magnets	Clean or replace
	Corroded connection	Clean or replace connectors
	Worn lining or magnets	Replace
	Scored or grooved brake drums	Machine or replace
	Poor Synchronisation	Correct Controller setting
	Poor Brake adjustment	Adjust Brakes
	Glazed brake Linings	Re-burnish or replace linings
Overloaded trailer	Correct loading. Check at weighbridge	
Brakes Locking	Poor Synchronising with controller	Adjust controller
	Poor Adjustment	Adjust brakes as per instructions
	Faulty controller	Test and rectify or replace
	Loose, bent or broken components	Inspect and replace components
	Insufficient wheel load (dual Axle)	Correct trailer level to even load
Intermittent brakes	Faulty controller	Test and Correct
	Broken Wires	Repair or replace
	Loose connections	Find and repair

Diagnosis and repairs of Brakes should only be done by a professional

# HANDY TIPS

## PREPERATION TIME

Make sure you give yourself optimal amount of time to prepare for any trip. Start planning at least 2 weeks ahead to make sure your caravan is in prime condition to safely get you to and from any adventure you take.

**KNOW YOUR MAINTENANCE SCHEDULE**, ensure you allow time for the initial service as well as maintenance and service at specified intervals.

- Wheel Bearings
- Seals
- Wheel studs and nuts

These spares are available from Ezytrail Campers

## PROTECTING THE ENVIRONMENT

Remote areas and National Parks are sensitive areas and all precautions should be taken not to damage tracks, interfere with flora and fauna and not to contaminate the area. In sensitive areas it is advisable to use grey water tanks and contained toilets. If your camper or caravan isn't fitted with such, both toilets and grey water tanks are available as portable self-contained units.

Always store food, food scraps and rubbish in secure containers, native animals can be quite resourceful in scavenging for scraps. Dingos have been known to open locked eskies to get to food so don't chance it, always secure these items when travelling.

## TRIP PLANNING

When planning remote trips always consider where you will resupply for fuel, food and water.

Some remote fuel stations may run out of fuel during busy periods or times when large fuel trucks are unable to access the area due to road conditions and closures or simply close outside of the season.

Always check conditions and availability of fuel before setting out to remote areas.

## SHIRE COUNCILS

There are many resources available for planning your trip away. Every state has a tourism website as so regional councils which will give you extensive information on camping sites, things to do and see, events happening in the area and contact information for booking sites or activities.

## NATIONAL PARKS

Each states national parks organisation have a website to assist in finding campsites and provide specific information about each parks unique qualities. As a planning resource these are extremely good. All contact information will be available.

## WIKICAMPS

This smartphone app is an excellent resource for finding all kinds of camping across Australia. If you are looking for free camping you won't find a better resource. There is an app add on that even assists in finding fuel stops with user updates on fuel prices.

## NATIONWIDE NETWORK

Ezytrail campers has a national network of branches



# WARRANTY STATEMENT

---

The following information relates to warranties offered by Ezytrail. Please read all the information carefully, and should you have any questions relating to any aspect of this section, then please contact Ezytrail. By purchasing an item from Ezytrail, you hereby agree to all terms and conditions of warranty as set out herein.

## VALIDITY OF CLAIMS

- Warranties are only valid to the original purchaser of the item in question and are valid from the original date of purchase only.
- Warranties apply only to items sold as "new" and do not extend to any items sold via auction, or deemed to be "factory seconds", "ex-demonstration" or "damaged" unless specifically stated otherwise by Ezytrail in writing. (Please see further on this page for more information).
- Warranties are not transferable under any circumstances. Similarly, if an item is sold to a third party by the original purchaser, then all warranties become null and void, and the original purchaser shall make no claims or be eligible for any claims on behalf of the new owner.
- Warranties do not apply to products purchased from Ezytrail and then used in hire schemes or as rentals.
- Ezytrail does not cover damage due to unauthorised modifications, misuse, abuse, incorrect assembly, improper and irregular maintenance, or accident or collision.
- Any work performed under an authorised warranty claim approved by Ezytrail must be performed by Ezytrail, or an authorised representative of Ezytrail and only with the express written permission of Ezytrail.
- Any affiliates, representatives, associates, agents, suppliers, resellers or similar of Ezytrail shall have no authority to authorise or deny warranty claims on behalf of Ezytrail.

Ezytrail shall not be liable, (in part or whole) for any warranties, either express or implied, made by agents or resellers on behalf of Ezytrail without the knowledge or express written permission of Ezytrail. Such unauthorised claims shall be the responsibility of the agent or reseller only.

## CARAVANS & CAMPER TRAILERS

Unless stated otherwise, caravans & trailers only are covered by a 12 month limited manufacturers warranty from the original date of purchase.

Our goods come with guarantees that cannot be excluded under the Australian Consumer Law.

You are entitled to a replacement or refund for a major failure and for compensation for any other reasonably foreseeable loss or damage.

You are also entitled to have the goods repaired or replaced if the goods fail to be of acceptable quality and the failure does not amount to a major failure.

## **ITEMS NOT COVERED UNDER WARRANTY INCLUDE:**

- Rust
- Wheels and Tyres
- Paint
- Travel Covers and Straps
- General consumables (eg bearings, light bulbs etc)
- Zips and mesh or screens are not covered.

In addition to Ezytrail warranty, the consumer may also be covered by other rights and remedies of Consumer Law in relation to the goods and or services to which this warranty relates

## **LODGING A CLAIM**

All warranty claims MUST BE LODGED through our website using our online Warranty Claim Form.

## **CONTACT**

If you have any further questions relating to warranties, or are unsure about any aspect of this section, then please contact us:

Phone: 1300 399 875

Online: [www.ezytrailcampertrailers.com.au/help-centre](http://www.ezytrailcampertrailers.com.au/help-centre)

# MAINTENANCE

---

Maintenance is essential to keep your caravan in a safe and usable condition. Caravans are no different to any other motor vehicle and require servicing at regular intervals which may vary according to use and the environment in which it is used. The service schedule outlines the service intervals for safe travelling and your owner obligations under our warranty policy. Servicing should always be carried out by a competent person with relevant experience.

**WARNING:**



- NEVER WORK BENEATH THE CARAVAN WHILE SUSPENDED ON A JACK. ALWAYS USE "JACK STANDS" WITH AN ADEQUATE SWL (SAFE WORKING LOAD).
- ALWAYS USE DEDICATED JACKING POINTS
- 240V APPLIANCES AND WIRING MUST ONLY BE SERVICED AND REPAIRED BY A QUALIFIED TRADESPERSON.
- GAS PLUMBING AND APPLIANCES MUST ONLY BE SERVICED AND REPAIRED BY A QUALIFIED GAS FITTER

# MAINTENANCE SCHEDULE

A=Adjust C=Clean I=Inspect T=Test R=Replace  
RCL=Remove/Clean/Lubricate

ITEM/COMPONENT	Daily In Use	CHECKED	3 Months/ 1,000Km		CHECKED
			ONROAD	OFFROAD	
BATTERY CONDITION	I		T	T	
HANDBRAKE CABLE	I		I/A	I/A	
BRAKE LININGS			A	A	
BREAKAWAY SYSTEM	I		I	I	
CHASSIS LUBE			I	I	
ELECTRIC WINCHES			I	I	
12V POWER SYSTEM			T	T	
HAND WINCHES			I	I	
HITCH	I		A	A	
240V POWER SYSTEM			T	T	
JOCKEY WHEEL	I		I/A	I/A	
LOCKS AND HINGES	I		I/A	I/A	
PANEL AND PAINT			I	I	
LPG SYSTEM	I		T	T	
PLUMBING SYSTEM	I		T	T	
SWIFT WATER HEATER			T	T	
TRUMA WATER HEATER	Refer to appliance manufacturers maintenance instructions for servicing and storage				
SEALS AND GROMMETS	I		I	I	
SIGNALLING LIGHTS	I/T		I/T	I/T	
STRUCTURAL FIXINGS	I		I/A	I/A	
SUSPENSION BUSHES			I	I	
SUSPENSION TORQUE			A	A	
TYRE PRESSURE	I		I/A	I/A	
VENT FILTERS			C	C	
WHEEL ALIGNMENT	I		I/A	I/A	
WHEEL BEARINGS			A	A	
WHEEL NUTS	I		I/A	I/A	



# MAINTENANCE SCHEDULE

A=Adjust C=Clean I=Inspect T=Test R=Replace  
RCL=Remove/Clean/Lubricate

ITEM/COMPONENT	2,500KM	CHECKED	6 Months/ 5,000KM		CHECKED
			ONROAD	OFFROAD	
BATTERY CONDITION	I		T	T	
HANDBRAKE CABLE	I		I/A	I/A	
BRAKE LININGS	I/A		A	I/C/A	
BREAKAWAY SYSTEM					
CHASSIS LUBE	L		I	L	
ELECTRIC WINCHES	I		I	I	
12V POWER SYSTEM	I		I	I	
HAND WINCHES	I		I/C	I/C	
HITCH	I		I	I/L/A	
240V POWER SYSTEM	I		I	I	
JOCKEY WHEEL	I		I	I	
LOCKS AND HINGES	I		I	I/C	
PANEL AND PAINT	I		I	I	
LPG SYSTEM	I		T	T	
PLUMBING SYSTEM	I/C		I/T	I/T	
TRUMA WATER HEATER	Refer to appliance manufacturers maintenance instructions for servicing and storage				
SEALS AND GROMMETS	I		I	I	
SIGNALLING LIGHTS	I/T		I/T	I/T	
STRUCTURAL FIXINGS	I		I	I/A	
SUSPENSION BUSHES	I		I	L	
SUSPENSION TORQUE	A		A	A	
TYRE PRESSURE	I/A		I/A	I/A	
VENT FILTERS	C		C	C	
WHEEL ALIGNMENT	I		I/A	I/A	
WHEEL BEARINGS	I		A	RCL	
WHEEL NUTS	I/A		I/A	I/A	

A=Adjust C=Clean I=Inspect T=Test R=Replace  
RCL=Remove/Clean/Lubricate

ITEM/COMPONENT	7,500KM	CHECKED	12 Months/ 10,000KM		CHECKED
			ONROAD	OFFROAD	
BATTERY CONDITION	I		T	T	
HANDBRAKE CABLE	I		I/A	I/A/L	
BRAKE LININGS	A		I/A	I/C/A	
BREAKAWAY SYSTEM			I	I	
CHASSIS LUBE	I		L	L	
ELECTRIC WINCHES	I		I	I/L	
12V POWER SYSTEM	I		I/T	I/T	
HAND WINCHES	I		I/C	I/C	
HITCH	I		I/L/A	I/L/A	
240V POWER SYSTEM	I		I/T	I/T	
JOCKEY WHEEL	I		I/L/A	I/L/A	
LOCKS AND HINGES	I		I/L/A	I/L/A	
PANEL AND PAINT	I		I	I	
LPG SYSTEM	I		I/T	I/T	
PLUMBING SYSTEM	I/C		I/T	I/T	
TRUMA WATER HEATER	Refer to appliance manufacturers maintenance instructions for servicing and storage				
SEALS AND GROMMETS	I		I	I	
SIGNALLING LIGHTS	I/T		I/T	I/T	
STRUCTURAL FIXINGS	I		I/A	I/A	
SUSPENSION BUSHES	I		L	RCL	
SUSPENSION TORQUE	A		A	A	
TYRE PRESSURE	I/A		I/A	I/A	
VENT FILTERS	C		C	C	
WHEEL ALIGNMENT	I		I/A	I/A	
WHEEL BEARINGS	I		RCL	RCL	
WHEEL NUTS	I/A		I/A	I/A	

# MAINTENANCE SCHEDULE

A=Adjust C=Clean I=Inspect T=Test R=Replace  
RCL=Remove/Clean/Lubricate

ITEM/COMPONENT	12,500KM	CHECKED	18 Months/ 15,000KM		CHECKED
			ONROAD	OFFROAD	
BATTERY CONDITION	I		T	T	
HANDBRAKE CABLE	I		I/A	I/A	
BRAKE LININGS	A		A	I/C/A	
BREAKAWAY SYSTEM					
CHASSIS LUBE	I		I	L	
ELECTRIC WINCHES	I		I	I	
12V POWER SYSTEM	I		I	I	
HAND WINCHES	I		I/C	I/C	
HITCH	I		I	I/L/A	
240V POWER SYSTEM	I		I	I	
JOCKEY WHEEL	I		I	I	
LOCKS AND HINGES	I		I	I/C	
PANEL AND PAINT	I		I	I	
LPG SYSTEM	I		T	T	
PLUMBING SYSTEM	I/C		I/T	I/T	
TRUMA WATER HEATER	Refer to appliance manufacturers maintenance instructions for servicing and storage				
SEALS AND GROMMETS	I		I	I	
SIGNALLING LIGHTS	I/T		I/T	I/T	
STRUCTURAL FIXINGS	I		I	I/A	
SUSPENSION BUSHES	I		I	L	
SUSPENSION TORQUE	A		A	A	
TYRE PRESSURE	I/A		I/A	I/A	
VENT FILTERS	C		C	C	
WHEEL ALIGNMENT	I		I/A	I/A	
WHEEL BEARINGS	I		A	RCL	
WHEEL NUTS	I/A		I/A	I/A	

A=Adjust C=Clean I=Inspect T=Test R=Replace  
RCL=Remove/Clean/Lubricate

ITEM/COMPONENT	17,500KM	CHECKED	24 Months/ 20,000KM		CHECKED
			ONROAD	OFFROAD	
BATTERY CONDITION	I		T	T	
HANDBRAKE CABLE	I		I/A/L	I/A/L	
BRAKE LININGS	A		I/C/A	I/C/A	
BREAKAWAY SYSTEM			I	I	
CHASSIS LUBE	I		L	L	
ELECTRIC WINCHES	I		I/L	I/L	
12V POWER SYSTEM	I		I/T	I/T	
HAND WINCHES	I		I/C	I/C	
HITCH	I		I/L/A	I/L/A	
240V POWER SYSTEM	I		I/T	I/T	
JOCKEY WHEEL	I		I/L/A	I/L/A	
LOCKS AND HINGES	I		I	I/L/A	
PANEL AND PAINT	I		I	I	
LPG SYSTEM	I		I/T	I/T	
PLUMBING SYSTEM	I/C		I/T	I/T	
TRUMA WATER HEATER	Refer to appliance manufacturers maintenance instructions for servicing and storage				
SEALS AND GROMMETS	I		I	I	
SIGNALLING LIGHTS	I/T		I/T	I/T	
STRUCTURAL FIXINGS	I		I/A	I/A	
SUSPENSION BUSHES	I		L	RCL	
SUSPENSION TORQUE	A		A	A	
TYRE PRESSURE	I/A		I/A	I/A	
VENT FILTERS	C		C	C	
WHEEL ALIGNMENT	I		I/A	I/A	
WHEEL BEARINGS	I		RCL	R	
WHEEL NUTS	I/A		I/A	I/A	

# MAINTENANCE SCHEDULE

A=Adjust C=Clean I=Inspect T=Test R=Replace  
RCL=Remove/Clean/Lubricate

ITEM/COMPONENT	22,500KM	CHECKED	30 Months/ 25,000KM		CHECKED
			ONROAD	OFFROAD	
BATTERY CONDITION	I		T	T	
HANDBRAKE CABLE	I		I/A	I/A	
BRAKE LININGS	A		A	I/C/A	
BREAKAWAY SYSTEM					
CHASSIS LUBE	I		I	L	
ELECTRIC WINCHES	I		I	I	
12V POWER SYSTEM	I		I	I	
HAND WINCHES	I		I/C	I/C	
HITCH	I		I	I/L/A	
240V POWER SYSTEM	I		I	I	
JOCKEY WHEEL	I		I	I	
LOCKS AND HINGES	I		I	I/C	
PANEL AND PAINT	I		I	I	
LPG SYSTEM	I		T	T	
PLUMBING SYSTEM	I/C		I/T	I/T	
TRUMA WATER HEATER	Refer to appliance manufacturers maintenance instructions for servicing and storage				
SEALS AND GROMMETS	I		I	I	
SIGNALLING LIGHTS	I/T		I/T	I/T	
STRUCTURAL FIXINGS	I		I	I/A	
SUSPENSION BUSHES	I		I	L	
SUSPENSION TORQUE	A		A	A	
TYRE PRESSURE	I/A		I/A	I/A	
VENT FILTERS	C		C	C	
WHEEL ALIGNMENT	I		I/A	I/A	
WHEEL BEARINGS	I		A	RCL	
WHEEL NUTS	I/A		I/A	I/A	

A=Adjust C=Clean I=Inspect T=Test R=Replace  
RCL=Remove/Clean/Lubricate

ITEM/COMPONENT	27,500KM	CHECKED	36 Months/ 30,000KM		CHECKED
			ONROAD	OFFROAD	
BATTERY CONDITION	I		T	T	
HANDBRAKE CABLE	I		I/A/L	I/A/L	
BRAKE LININGS	A		I/C/A	I/C/A	
BREAKAWAY SYSTEM			I	I	
CHASSIS LUBE	I		L	L	
ELECTRIC WINCHES	I		I/L	I/L	
12V POWER SYSTEM	I		I/T	I/T	
HAND WINCHES	I		I/C	I/C	
HITCH	I		I/L/A	I/L/A	
240V POWER SYSTEM	I		I/T	I/T	
JOCKEY WHEEL	I		I/L/A	I/L/A	
LOCKS AND HINGES	I		I	I/L/A	
PANEL AND PAINT	I		I	I	
LPG SYSTEM	I		I/T	I/T	
PLUMBING SYSTEM	I/C		I/T	I/T	
TRUMA WATER HEATER	Refer to appliance manufacturers maintenance instructions for servicing and storage				
SEALS AND GROMMETS	I		I	I	
SIGNALLING LIGHTS	I/T		I/T	I/T	
STRUCTURAL FIXINGS	I		I/A	I/A	
SUSPENSION BUSHES	I		L	RCL	
SUSPENSION TORQUE	A		A	A	
TYRE PRESSURE	I/A		I/A	I/A	
VENT FILTERS	C		C	C	
WHEEL ALIGNMENT	I		I/A	I/A	
WHEEL BEARINGS	I		RCL	R	
WHEEL NUTS	I/A		I/A	I/A	

# MAINTENANCE SCHEDULE

A=Adjust C=Clean I=Inspect T=Test R=Replace  
RCL=Remove/Clean/Lubricate

ITEM/COMPONENT	32,500KM	CHECKED	42 Months/ 35,000KM		CHECKED
			ONROAD	OFFROAD	
BATTERY CONDITION	I		T	T	
HANDBRAKE CABLE	I		I/A	I/A	
BRAKE LININGS	A		A	I/C/A	
BREAKAWAY SYSTEM					
CHASSIS LUBE	I		I	L	
ELECTRIC WINCHES	I		I	I	
12V POWER SYSTEM	I		I	I	
HAND WINCHES	I		I/C	I/C	
HITCH	I		I	I/L/A	
240V POWER SYSTEM	I		I	I	
JOCKEY WHEEL	I		I	I	
LOCKS AND HINGES	I		I	I/C	
PANEL AND PAINT	I		I	I	
LPG SYSTEM	I		T	T	
PLUMBING SYSTEM	I/C		I/T	I/T	
TRUMA WATER HEATER	Refer to appliance manufacturers maintenance instructions for servicing and storage				
SEALS AND GROMMETS	I		I	I	
SIGNALLING LIGHTS	I/T		I/T	I/T	
STRUCTURAL FIXINGS	I		I	I/A	
SUSPENSION BUSHES	I		I	L	
SUSPENSION TORQUE	A		A	A	
TYRE PRESSURE	I/A		I/A	I/A	
VENT FILTERS	C		C	C	
WHEEL ALIGNMENT	I		I/A	I/A	
WHEEL BEARINGS	I		A	RCL	
WHEEL NUTS	I/A		I/A	I/A	

A=Adjust C=Clean I=Inspect T=Test R=Replace  
RCL=Remove/Clean/Lubricate

ITEM/COMPONENT	37,500KM	CHECKED	48 Months/ 40,000KM		CHECKED
			ONROAD	OFFROAD	
BATTERY CONDITION	I		T	T	
HANDBRAKE CABLE	I		I/A/L	I/A/L	
BRAKE LININGS	A		I/C/A	I/C/A	
BREAKAWAY SYSTEM			I	I	
CHASSIS LUBE	I		L	L	
ELECTRIC WINCHES	I		I/L	I/L	
12V POWER SYSTEM	I		I/T	I/T	
HAND WINCHES	I		I/C	I/C	
HITCH	I		I/L/A	I/L/A	
240V POWER SYSTEM	I		I/T	I/T	
JOCKEY WHEEL	I		I/L/A	I/L/A	
LOCKS AND HINGES	I		I	I/L/A	
PANEL AND PAINT	I		I	I	
LPG SYSTEM	I		I/T	I/T	
PLUMBING SYSTEM	I/C		I/T	I/T	
TRUMA WATER HEATER	Refer to appliance manufacturers maintenance instructions for servicing and storage				
SEALS AND GROMMETS	I		I	I	
SIGNALLING LIGHTS	I/T		I/T	I/T	
STRUCTURAL FIXINGS	I		I/A	I/A	
SUSPENSION BUSHES	I		L	RCL	
SUSPENSION TORQUE	A		A	A	
TYRE PRESSURE	I/A		I/A	I/A	
VENT FILTERS	C		C	C	
WHEEL ALIGNMENT	I		I/A	I/A	
WHEEL BEARINGS	I		RCL	R	
WHEEL NUTS	I/A		I/A	I/A	



# MAINTENANCE SCHEDULE

A=Adjust C=Clean I=Inspect T=Test R=Replace  
RCL=Remove/Clean/Lubricate

ITEM/COMPONENT	42,500KM	CHECKED	54 Months/ 45,000KM		CHECKED
			ONROAD	OFFROAD	
BATTERY CONDITION	I		T	T	
HANDBRAKE CABLE	I		I/A	I/A	
BRAKE LININGS	A		A	I/C/A	
BREAKAWAY SYSTEM					
CHASSIS LUBE	I		I	L	
ELECTRIC WINCHES	I		I	I	
12V POWER SYSTEM	I		I	I	
HAND WINCHES	I		I/C	I/C	
HITCH	I		I	I/L/A	
240V POWER SYSTEM	I		I	I	
JOCKEY WHEEL	I		I	I	
LOCKS AND HINGES	I		I	I/C	
PANEL AND PAINT	I		I	I	
LPG SYSTEM	I		T	T	
PLUMBING SYSTEM	I/C		I/T	I/T	
TRUMA WATER HEATER	Refer to appliance manufacturers maintenance instructions for servicing and storage				
SEALS AND GROMMETS	I		I	I	
SIGNALLING LIGHTS	I/T		I/T	I/T	
STRUCTURAL FIXINGS	I		I	I/A	
SUSPENSION BUSHES	I		L	L	
SUSPENSION TORQUE	A		A	A	
TYRE PRESSURE	I/A		I/A	I/A	
VENT FILTERS	C		C	C	
WHEEL ALIGNMENT	I		I/A	I/A	
WHEEL BEARINGS	I		A	RCL	
WHEEL NUTS	I/A		I/A	I/A	

A=Adjust C=Clean I=Inspect T=Test R=Replace  
RCL=Remove/Clean/Lubricate

ITEM/COMPONENT	47,500KM	CHECKED	60 Months/ 50,000KM		CHECKED
			ONROAD	OFFROAD	
BATTERY CONDITION	I		T	T	
HANDBRAKE CABLE	I		I/A	I/A/L	
BRAKE LININGS	A		I/A	I/C/A	
BREAKAWAY SYSTEM			I	I	
CHASSIS LUBE	I		L	L	
ELECTRIC WINCHES	I		I/L	I/L	
12V POWER SYSTEM	I		I/T	I/T	
HAND WINCHES	I		I/C	I/C	
HITCH	I		I/L/A	I/L/A	
240V POWER SYSTEM	I		I/T	I/T	
JOCKEY WHEEL	I		I/L/A	I/L/A	
LOCKS AND HINGES	I		I	I/L/A	
PANEL AND PAINT	I		I	I	
LPG SYSTEM	I		I/T	I/T	
PLUMBING SYSTEM	I/C		I/T	I/T	
TRUMA WATER HEATER	Refer to appliance manufacturers maintenance instructions for servicing and storage				
SEALS AND GROMMETS	I		I	I	
SIGNALLING LIGHTS	I/T		I/T	I/T	
STRUCTURAL FIXINGS	I		I/A	I/A	
SUSPENSION BUSHES	I		L	RCL	
SUSPENSION TORQUE	A		A	A	
TYRE PRESSURE	I/A		I/A	I/A	
VENT FILTERS	C		C	C	
WHEEL ALIGNMENT	I		I/A	I/A	
WHEEL BEARINGS	I		RCL	RCL	
WHEEL NUTS	I/A		I/A	I/A	

# WINTON 10 FLY AWNING

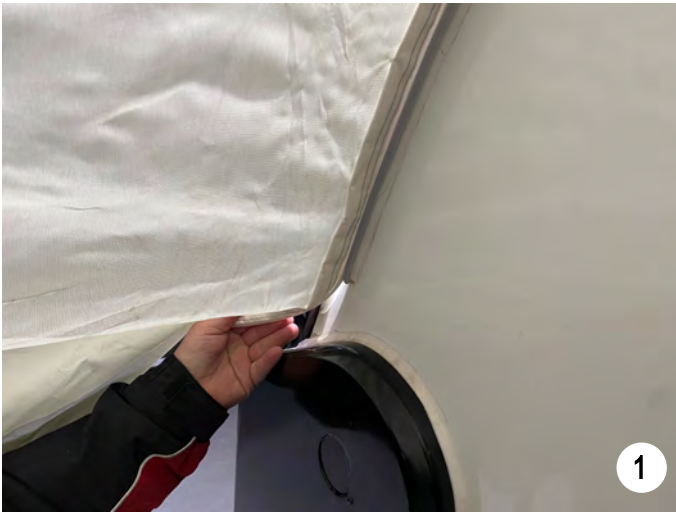

1. Slide awning from back to front in rail
2. Insert corner poles
3. Attach guy ropes on each side
4. Insert centre pole through annex
5. Re-adjust guide ropes to suit

↗ DOMETIC  
**AWNINGS**  
44  
**SUNSHINE AIR PRO**

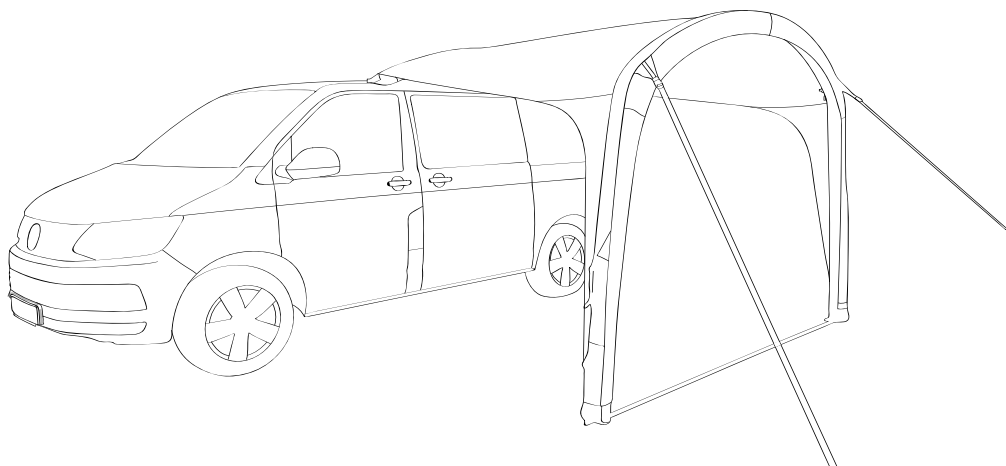

SUITABLE FOR:

**SUNSHINE AIR PRO VW**

**Sunshine AIR Pro VW**

User Guide.....4

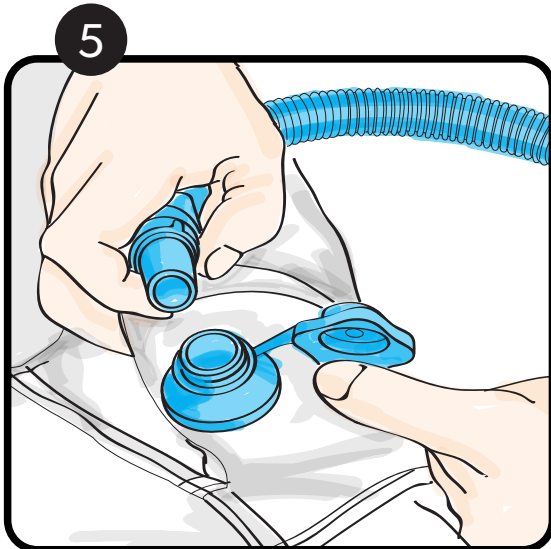
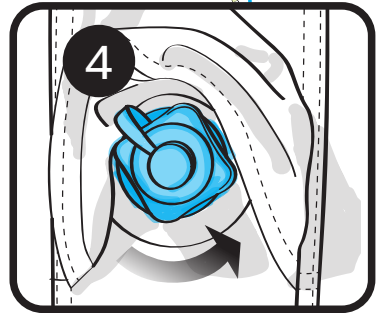
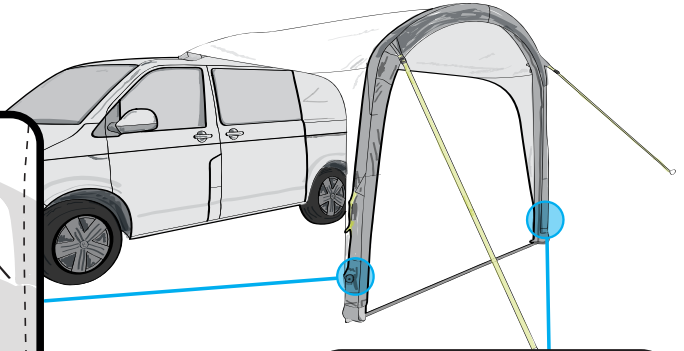
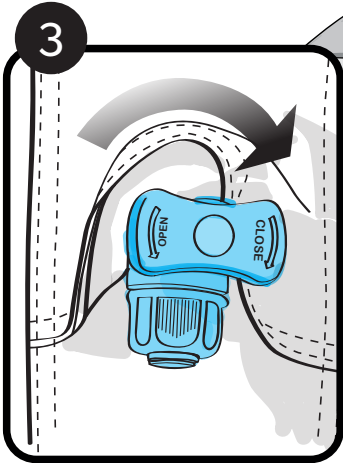
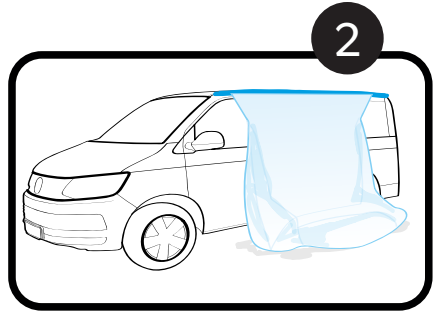
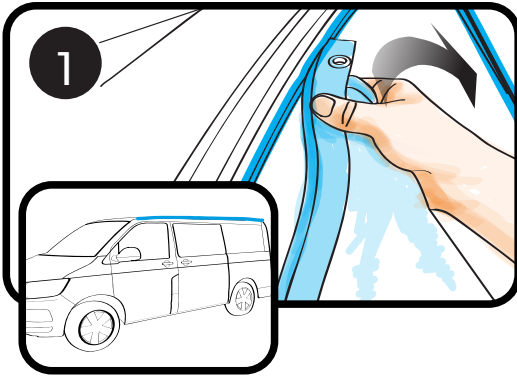

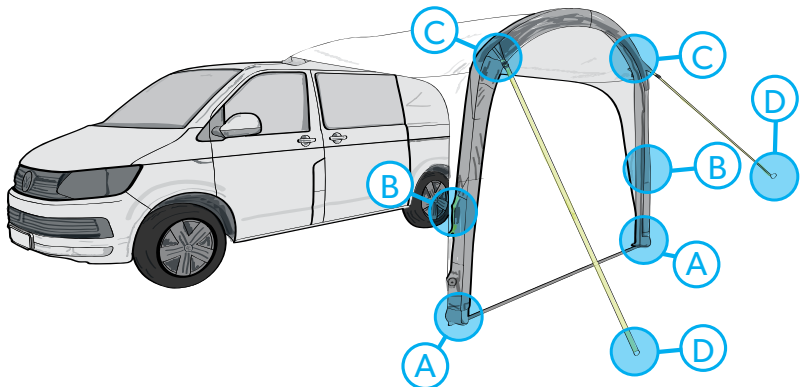
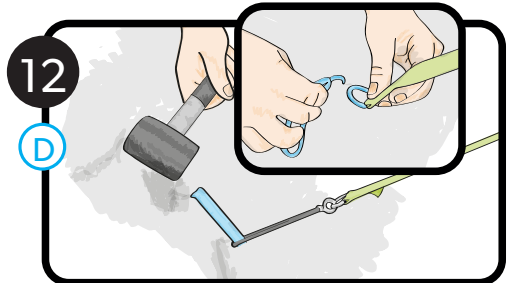
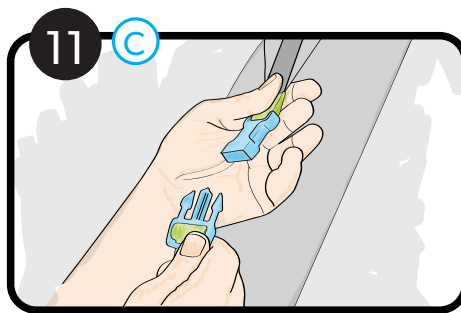
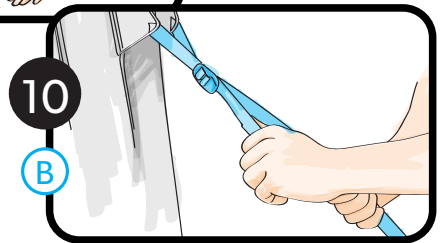
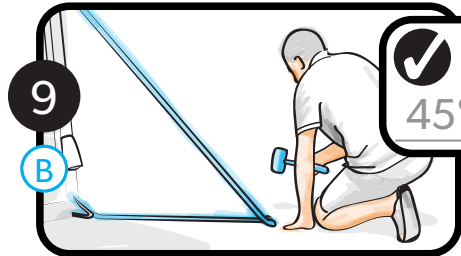
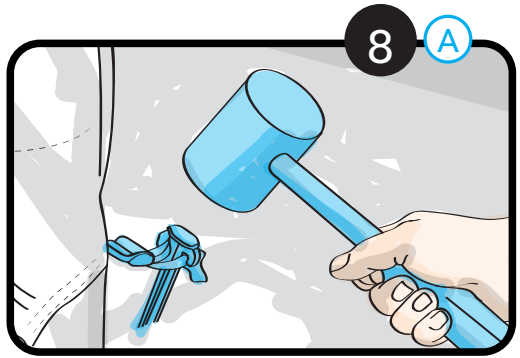
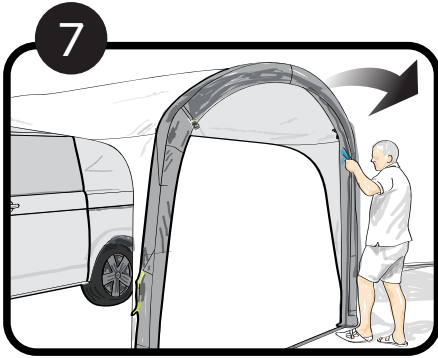

# OPTIONAL SIDE WALL

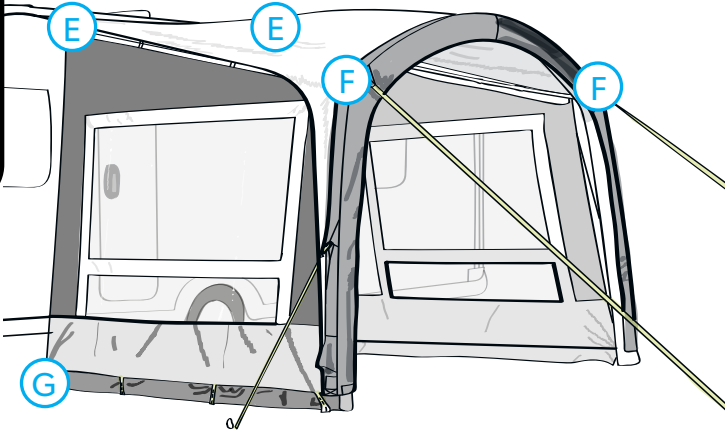
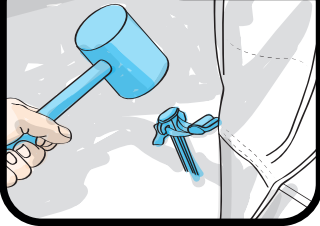
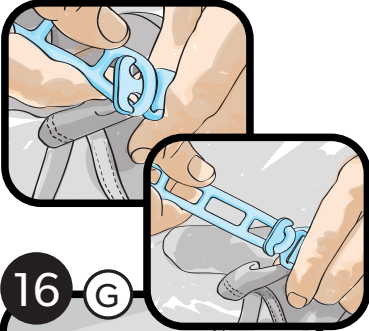
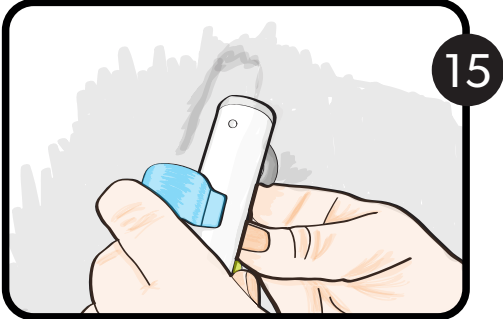
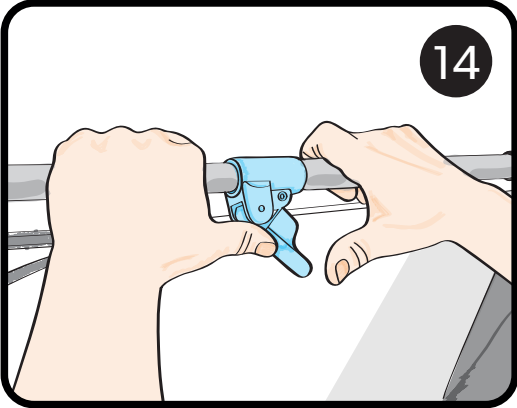
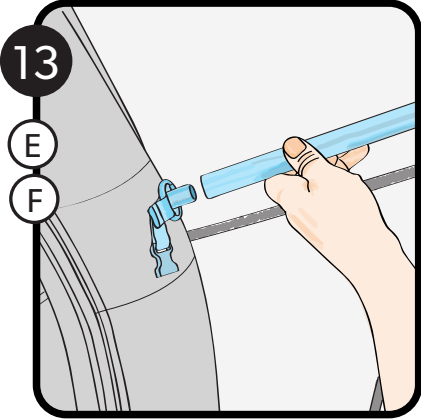

## Welcome

Thank you for purchasing your Dometic awning. Please read these instructions carefully before attempting set up and retain for future reference. If used properly, your awning should give you years of trouble free use. We recommend that your awning is insured against accidental and storm damage as this is not covered by the warranty.



### **IMPORTANT - PLEASE READ:**

Fabrics can be weakened by prolonged exposure to sunlight. Under normal holiday use your awning will give long service but use for extended periods in strong sunlight will soon cause deterioration. In those cases it would be wise to use a site as shaded as possible. UV degradation is not covered under the warranty. The warranty does not cover products on permanent sites, displays or for commercial purposes.

The awning material has a water repellent PU coating over its entire surface and the main seams of your awning have been factory taped to help prevent leakage. To increase the water resistance of the seams, seam sealant can be used. Seam sealant should also be applied to areas where the taping is damaged or has peeled away through wear and tear. It can also be applied to areas where a leak may have developed. Dometic seam sealant is available for purchase through your local retailer or [dometic.com](http://dometic.com).

The awning keder beading is sewn to the awning with a special water repellent sewing thread. This thread swells when wet to fill the needle holes but the thread needs to become wet several times before it is totally effective. This process is known as 'weathering' and it may take several soakings for the weathering to be fully effective. This area can also be treated with seam sealant.



The products are meant to be used in weather conditions not exceeding the Beaufort scale 7, and in such conditions above this measurement the product should be packed away rather than left standing. In conditions where rainfall is expected to exceed 30 mm in 24 hour period there may be a potential for leakage to occur. The product is not meant for commercial use and should not be left in the open for extended periods. We recommend a trial run before using your awning for the first time. This will allow you to familiarise yourself with the awning, its set up and any limitations the awning may have for your particular use.



## Set-Up

Slide the awning keder beading, on the rear of the awning roof (see Diagram 1), through the awning channel until it is in your required position (see Diagram 2).

Locate the deflation valves at the bottom of each of the AirPoles (3). Ensure that the deflation valves are closed by turning the tap clockwise 90° (see Diagram 3).

Locate the inflation valve on the awning (4). Unscrew the top cap and attach the pump nozzle (5). Start to pump (6).

Once the awning has a good amount of air in it, pull the front of the awning outwards so that the AirPoles can assume their correct shape (7).

**Pegging Point A:** Peg the corners of the awning (8a). Each corner should be pegged vertically in-line with the top of the canopy, at an equal distance away from the vehicle and in-line with each other.

Pegging point B: Loosen the quick pitch straps and peg them out diagonally from the corners (9b). Tighten the quick pitch straps once in position (10b).

Clip the storm straps into place (11c) and hook the pegging “O” ring onto the bottom of the strap (12d) and peg. Keep pumping until the ideal inflation pressure of 9 psi (0.62 BAR) is achieved. If necessary take a rest before adding more pressure.

## Optional Side Wall Set-Up

Push the open ends of the pole onto the connection points inside the front and rear corners of the awning (13ef).

Clip the hooks at the top of the side wall fabric to the long pole (14).

Use the locking mechanism (15) once in place to stabilise the pole and help keep side walls taut.

Attach the ladder pegging straps to the anchor points located at the bottom of the side walls, then peg (16g).

# Fiamma F45S Royal Grey Awning

## Awning Operation

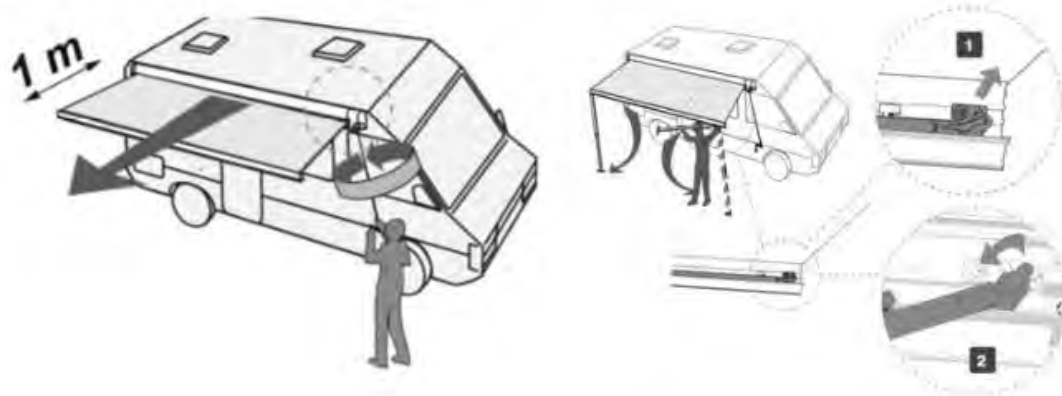

Fig. 6 - Partially Open Awning and Release Legs.

- In order to avoid unnecessary strain on the awning as well as on the vehicle side, we suggest to take out the legs at about 1 m from the opening.
- Grasp the leg near its hinge-joint and pull it toward you. Unhook and lower the leg.

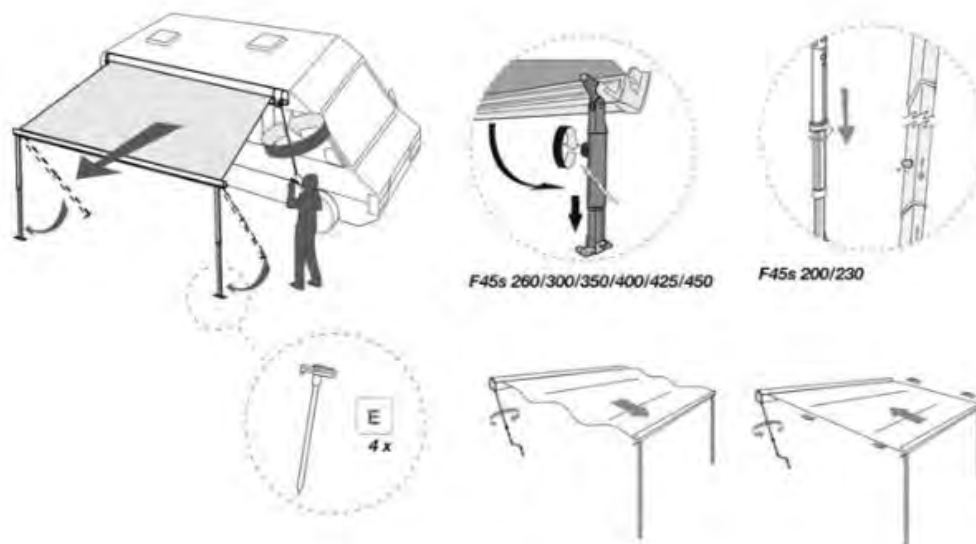

Fig. 7 - Peg Down and Tighten Fabric.

# Fiamma F45S Royal Grey Awning

- After unrolling the awning completely, adjust the legs at the chosen height. To avoid the awning being lifted up by an unexpected gust of wind, it is necessary to secure the legs to the ground with the provided hooks.
- For safety's sake, we strongly advise you to anchor the awning with the Tie-Down (Optional).

---

## Closing Awning

We remind you that the awning is a sun protection, so please close your awning in case of rain, wind or snow. Otherwise, please take the following precautions: lower one side of your awning, so that water can flow away and place the tension rafter

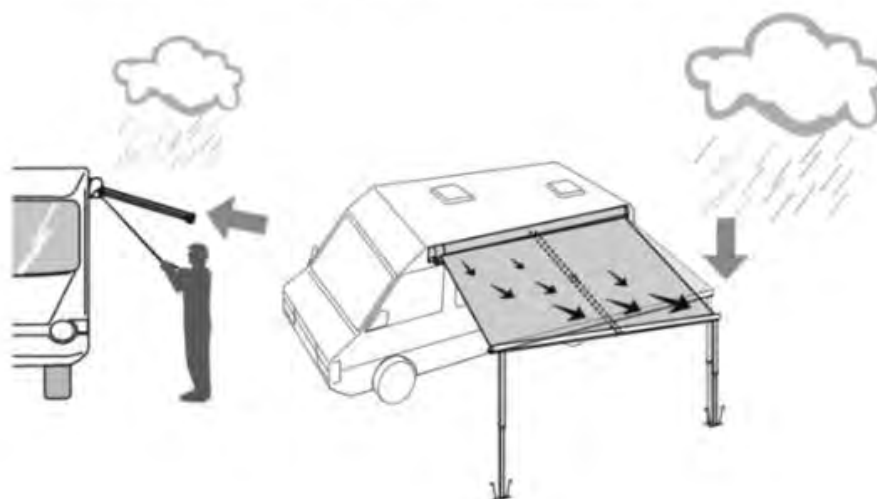

*Fig. 8 - Lower One Side to Assist Water Flow When Raining. .*

The foot for leg has been created to prevent its incorrect placing inside the housing of the lead bar during the closing phase of the awning. With an incorrect placing of the foot the lead bar will not close completely; therefore it is advisable to always place it properly into the housing with the base turned to the lead bar. (Figure 9)

# Fiamma F45S Royal Grey Awning

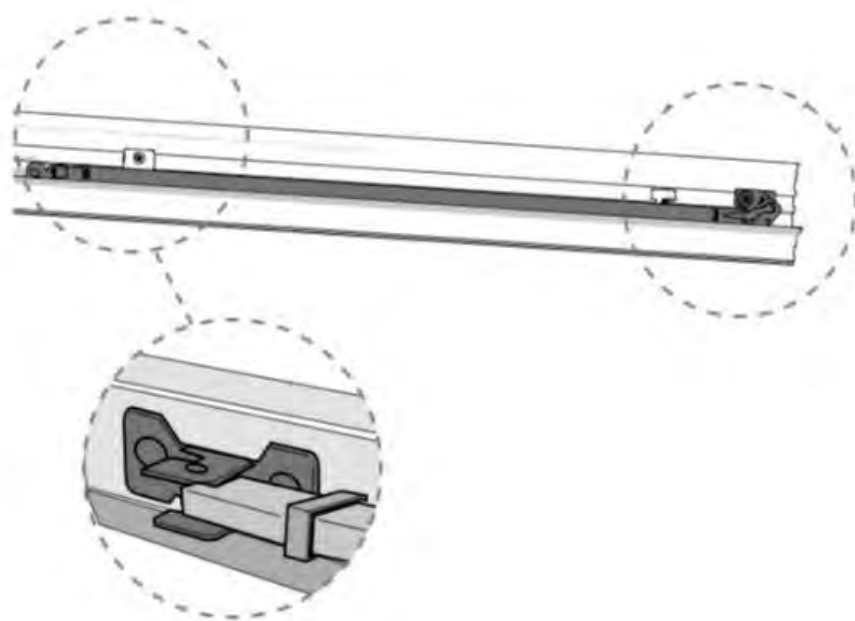

*Fig. 9 - Correct Positioning of Leg and Foot*

If the awning is still open, the red flag is visible. When the awning is completely closed, the red flag is no longer visible.



*Fig. 10 - Opened Awning Indicator*



## **VICTORIA**

### **Kilsyth**

#### **Branch Office**

Lot 1, 97-107 Canterbury Road

Kilsyth VIC 3137

P:03 9728 3147

### **Cambellfield**

#### **Branch Office**

1924 Sydney Road

Campbellfield VIC 3061

P:03 9357 9603

### **Geelong**

#### **Branch Office**

2 Sharon Court

North Geelong VIC 3215

P:03 5260 2900

## **NEW SOUTH WALES**

### **Lansvale**

#### **Branch Office**

178-180 Hume Hwy

Lansvale

NSW 2166

P:02 9754 2176

### **Penrith**

#### **Branch Office**

22 Lemko Place Penrith NSW  
2750

P:02 4701 5782

## **Newcastle**

### **Branch Office**

5 Archibald Place

Heatherbrae NSW 2324

P:02 9754 2176

## **Coffs Harbour**

### **COFFS CANVAS &**

#### **CAMPERS**

1 Keona Court

Coffs Harbour NSW 2450

P:02 6651 2960

## **QUEENSLAND**

### **Sunshine Coast**

#### **Branch Office**

55-57 Lear Jet Drive

Caboolture QLD 4510

P:07 5348 0240

## **Townsville**

### **Branch Office**

62 Punari Street Currajong

QLD 4812

P:07 4725 3806

## **SOUTH AUSTRALIA**

### **Adelaide**

#### **Branch Office**

283 North East Road

Hampstead Gardens SA 5086

P:08 8261 5865

## **WESTERN AUSTRALIA**

### **Canning Vale**

#### **Branch Office**

Unit 1, 196 Bannister Road

Canning Vale WA 6155

P:08 9455 1454

## **Wangara**

### **Branch Office**

Unit 1, 33 Dellamarta Road

Wangara WA 6065

P:08 9309 4000

## **ACT**

### **Canberra**

#### **TRAILER CAMPER**

#### **AUSTRALIA**

3 Whyalla Street Fyshwick  
NSW 2609

P:1300 010 513